



## *JBNA ZOOM discussion* *Wednesday, October 14<sup>th</sup>, 2020*

- ✧ Welcome & Program
- ✧ Correspondence & Announcements
- ✧ Puerto Vallarta Amigos
  - ✧ Ramesh Espinoza
- ✧ 557 Simcoe Rezoning
  - ✧ Mark Imhoff & Laura Nixon
- ✧ Community Voices







June 2020

FISHERMAN'S WHARF - BASE PLAN  
For Information Only



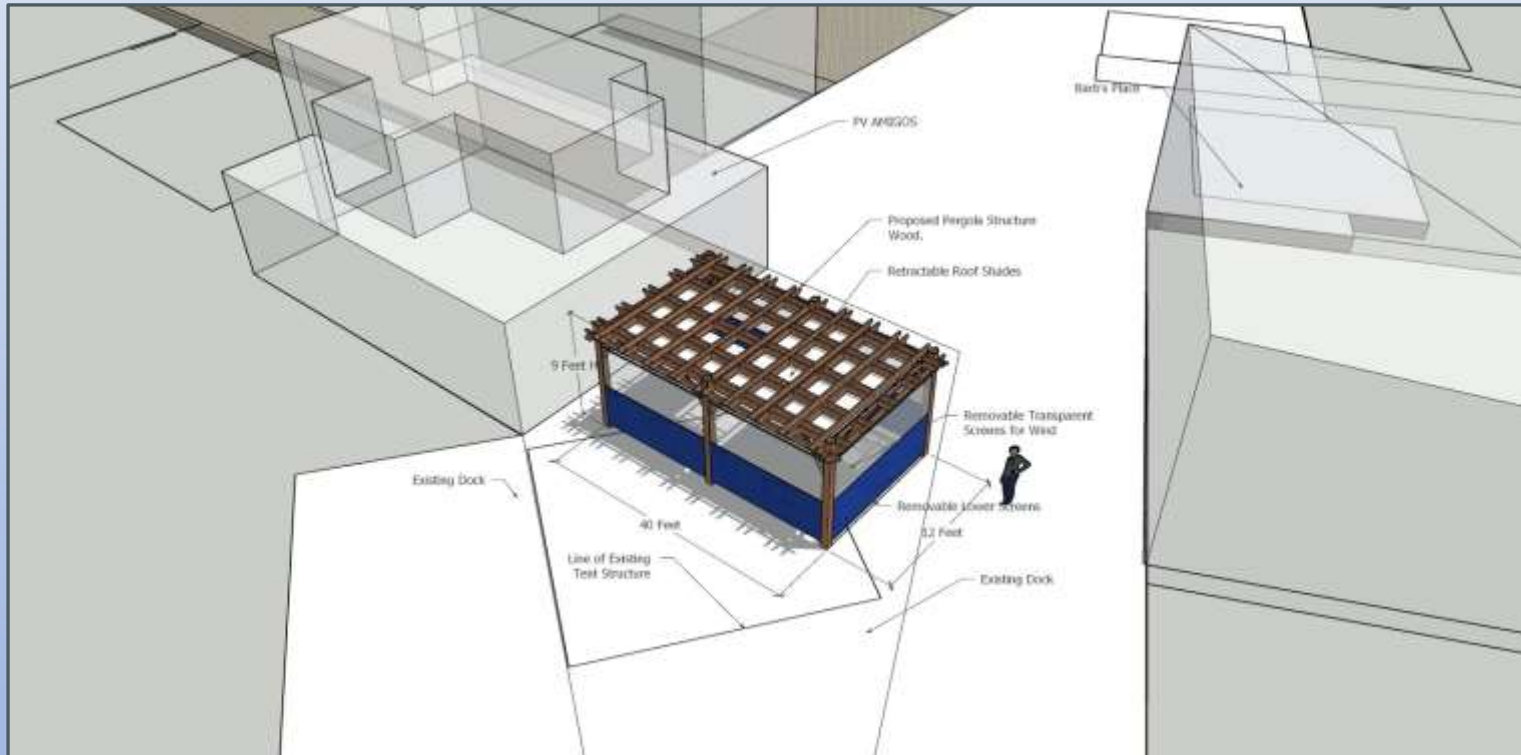



---

*your questions ?*

---



# **GLOBAL CRUISE/ACTIVIST NETWORK**

**K**  
**Kilo**

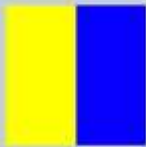

"I wish to communicate with you."

**L**  
**Lima**



"You should stop your vessel instantly."



1. Self-determination of communities
  2. Economic impacts
  3. Cultural impacts
  4. Labor
  5. Climate Change
  6. Air Pollution
  7. Water Pollution
  8. Monitoring & Transparency
  9. Environment & Biodiversity
  10. Public Health
  11. Crime Victims
  12. Worker Repatriation
- 

Principles  
of  
Responsible  
Cruise  
Tourism



---

*your priorities ?*

---